

**CDM-GYM** systems are lightweight high performance acoustic floating floors for gyms and fitness areas that can be designed to provide different system heights and meet the highest acoustic performance requirements.

To allow the selection of the best solution for the different gym activities, CDM-GYM standard solutions are combining different impact absorption, load distribution and resilient support layers.

**CDM-GYM-SP** is the "Standard Performance" gym system, it is a continuous support floating floor with an installation depth between 100 and 125 mm perfect for **general rooms** (suitable for aerobic, zumba, yoga, pilates, circuit training, group fitness areas, martial arts and spinning studios).



### CHARACTERISTICS

- li. A variety of load distribution components can be used, such as plywood or OSB board
- li. Two impact absorption layers are available: CDM-GYMPACT20 & CDM-GYMPACT45 (the selection is made depending on the type of gym activities)
- li. The floor covering is not included in standard CDM-GYM solutions but a CDM Sports Floor range is available upon request
- li. CDM-GYM systems are compatible with almost all types of gym floor covering  
Please check with CDM & floor manufacturer prior to installation



### BENEFITS

- li. Engineered floating floor systems can be designed to accommodate different system depths
- li. Lightweight floating floor options with reduced/minimal overall thickness (low additional height and weight)
- li. Tested and proven high levels of isolation performance, particularly at low frequencies
- li. Quick and easy installation
- li. Long-lasting and maintenance free
- li. Cost effective high performance solution
- li. If required, CDM-GYM can easily be dismantled and reinstalled at another venue



### ACOUSTICAL RESULTS: DROP-WEIGHT TESTS

Test Report Riverbank AN17-010\* and AN19-005\* - Test Setups

- 9,5 mm rubber sports floor
- CDM-GYMPACT20 or CDM-GYMPACT45
- Plywood 19 mm
- CDM-DAMP
- Plywood 19 mm
- CDM-MTX
- Concrete slab 200 mm

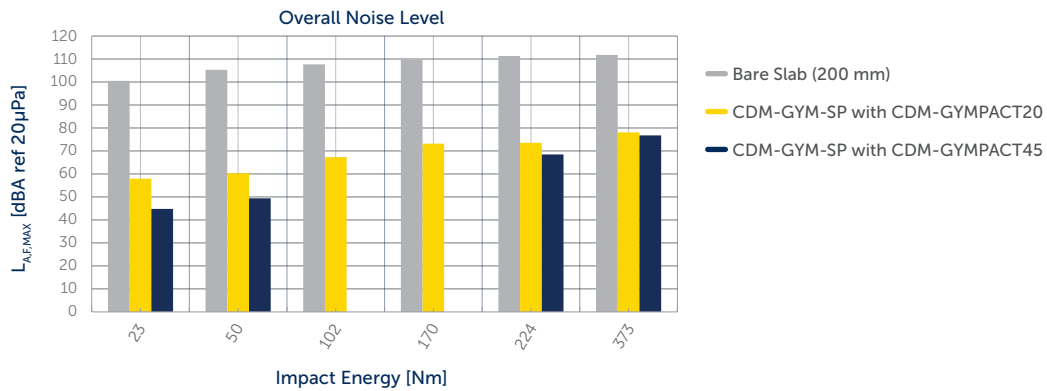

### ACOUSTICAL RESULTS

Test Report Riverbank IN17-40\* and IN19-034\* - Test Setups

Note: the test setups are the same as used for the drop-weight test.

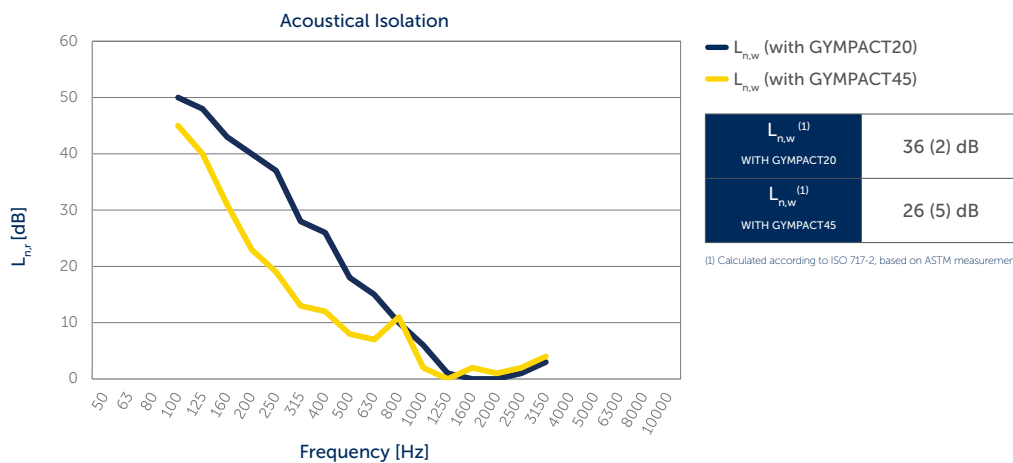

\*Test report available upon request.



### TYPICAL ASSEMBLY

#### CDM-GYM-SP

1. Structural slab
2. CDM-PERIMETER
3. CDM-MTX
4. Plywood load distribution layer 1 (or other suitable load distribution layer)
5. CDM-DAMP
6. Plywood load distribution layer 2 (or other suitable load distribution layer)
7. CDM-GYMPACT\*\*
8. Floor covering

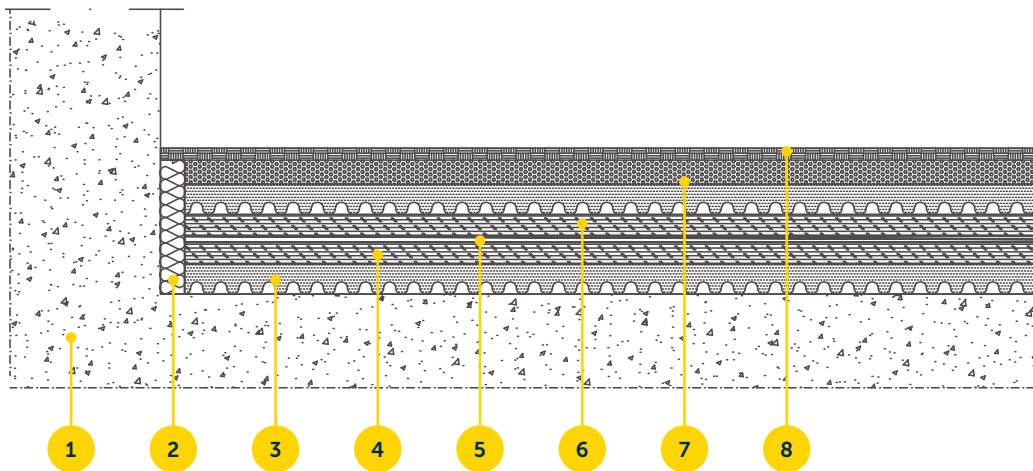

**Note:** additional information about installation is available upon request.

\*\*All CDM-GYM standard solutions can be combined with different CDM-GYMPACT layers. The right selection of CDM-GYMPACT allows choosing the best solution for the different gym activities.

### DISCLAIMER

This information is accurate to the best of our knowledge at the time of issue. Information, data and recommendations provided are based on industry accepted testing and prior product usage. It is intended as descriptive of the general capabilities and performance of our products and does not endorse applicability for any particular project. We reserve the right to change products, performance, and data without notice. This document replaces all information supplied prior to the publication hereof.



## Delta-L B.V. | CDM Nederland

Delta-L is specialist op het gebied van geluidsisolatie en trillingsisolatie en ontwerpt, levert en monteert diverse systemen voor akoestische ontkoppelingen in de bouw en industrie.

Delta-L vertegenwoordigt CDM op de Nederlandse markt. CDM is opgericht in 1951 en is marktleider op het gebied van akoestische oplegsystemen voor de bouw en industrie en is actief in tientallen landen (30+ vestigingen wereldwijd).

Door onze expertise, jarenlange ervaring en grote database aan meetresultaten van zowel interne en externe laboratorium metingen als in situ metingen hebben we door de jaren heen een uitgebreid assortiment aan akoestische materialen ontwikkeld, welke we op een slimme manier verwerken in diverse akoestische systemen.

Tevens zijn wij hierdoor in staat u adequaat van dienst te zijn bij elke stap in het proces: analyse van het geluid of trilling probleem, het aanleveren van een akoestisch ontwerp, optimalisatie van het ontwerp, productie, levering en montage.

Er wordt continu gewerkt aan innovatie en optimalisatie van de akoestische systemen om uw wensen en eisen om te zetten in een deskundig advies op maat.

## Contactinfo

T 0800 55555 44

E [info@delta-l.nl](mailto:info@delta-l.nl)

I [www.delta-l.nl](http://www.delta-l.nl)